



Nature Cottage

My Fairy Garden® Leaflet

Create your own magical
fairy garden playset!



Plants and growth may vary.



About My Fairy Garden®

Did you know that fairies are everywhere? They are! Not everyone can see them, but for those of us who can, they're a magical sight! Fairies love nature, so you'll usually find them near flowers, trees and toadstools, or among other wild and beautiful plants. You can invite fairies into your home by creating magical gardens...it's true! They will quickly become your friends when you give them a lovely home and help them care for it!



This set includes everything you'll need to make a special Nature Cottage for the fairy Isla! Isla is known as "Mother Nature" among her fairy friends because she devotes her time to taking care of all the critters found in nature around her. Her cottage is always open to friends who wish to visit or stay a while and enjoy her garden. Isla has a particular soft spot for ladybugs, and proudly maintains a cozy bug house just for them!

Once you build Isla's Nature Cottage, and start growing your garden, you can make it even more enchanting by adding your own flowers and decorations!

Contents: Flowerpot Cottage, Bridge, Bug House, Mushroom Chimney, Wind Spinner, Water Barrel, Lily Pad, Table, Tea Set, 2 Ladybugs, Butterfly, Isla the Fairy, Freckles the Frog, Fairy Stand, Flying Cord, Garden Tool, Seeds, Fairy Seed Starter



Assembling Your Fairy Garden

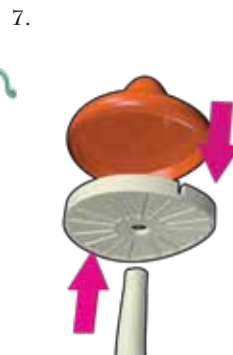
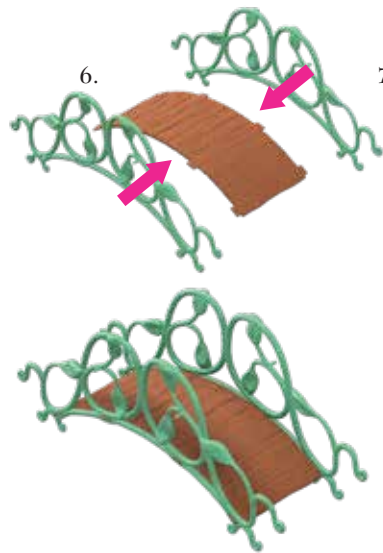
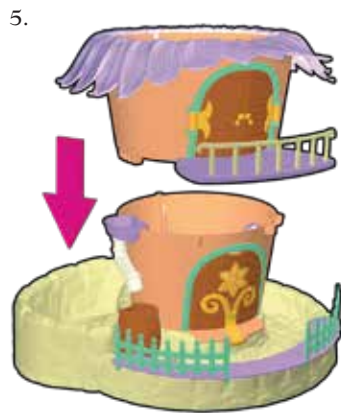
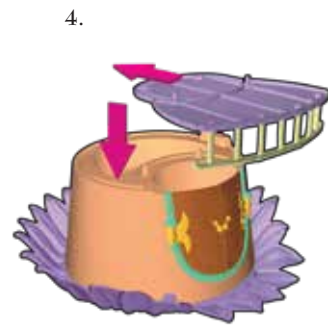
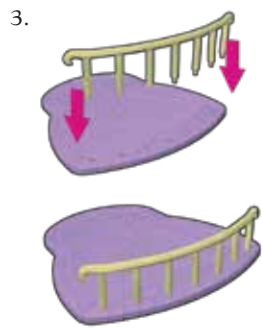
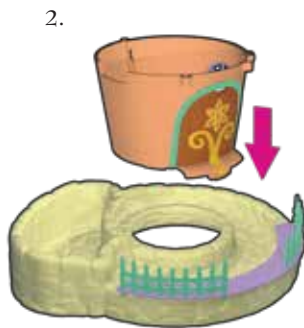
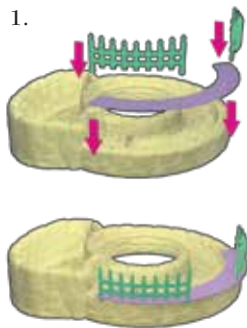

Creating Your Fairy Garden

9.



Once you have assembled your Nature Cottage, add the Fairy Seed Starter to the area(s) where you wish to grow your garden.

Tip: You may want to mix your own soil with the Fairy Seed Starter to add nutrients to your garden and improve growing results.

10.



Add water to the Fairy Seed Starter – enough that it is moist but not leaving any water sitting at the bottom. The Fairy Seed Starter will get darker to show that it is wet.

Evenly scatter seeds on all of the Fairy Seed Starter areas. Sprinkle them evenly about 1/8" to 1/4" apart. Using your gardening tool, gently press the seeds down, and then sprinkle a little more Fairy Seed Starter over the seeds. Sprinkle or spray water on the Fairy Seed Starter.

Tip: Planting seeds too close together will cause them to crowd each other out.

11.



Tip: For quicker germination, a plastic bag can be placed over the entire set to hold moisture in.

What is Fairy Seed Starter?

It looks magical, but it's actually vermiculite, a micro rock mined from the ground. It's an ideal environment for seeds to sprout because it holds a lot of water while remaining airy.

Caring for Your Fairy Garden

Check the dampness of your Fairy Seed Starter each day to make sure it does not dry out. Water as needed.

To water your garden, you can use the water barrel – just remove it from the cottage and fill it with water to pour onto your garden! Just be sure to put it back because if you overwater the top area, you'll want the water to trickle down into the barrel!

Tip: If you overwater the bottom area, ask an adult to gently tip it and pour water out, or soak it up with a paper towel.

Put your fairy garden near a window that gets western or southern sun, and rotate your garden daily.

Tip: Place your fairy garden on a sturdy surface so it won't fall or get knocked over!

Depending on the temperature and location, the seeds will take about three to seven days to start growing. Your seed mix contains three types of plants, and they all grow differently and at different rates. First you will see sprouts come up through the soil, and then you will start seeing some leaves!

Tip: Once your plants have begun growing, you may want to transplant your garden by switching out the Fairy Seed Starter with your own soil, to continue nurturing and growing plants. Ask an adult for help! You can also replant using your own favorite seeds or flowers!



Note: Plants and growth will vary.

Make it Your Own

Add any decorations or accessories you want! Fairies like rocks, pebbles, flowers, twigs, shells, etc. You can even arrange the furniture inside of the flowerpot! Want to add some flowers or plants? You can do that too! We've given you enough to get started, but go ahead and make it special!



Play!

As your garden grows, you get to have fun playing with Isla and Freckles! Set them in the garden, or inside the flower pot! Use the stand to help Isla stay on her own, or attach the magical flying cord to Isla's back and to the cottage roof or base and make her look like she's flying!



You can collect other fairies, friends and accessories for even bigger fun!



How Do Fairy Gardens Grow?

After following the guide, you know how to plant and water the seeds, but how do your plants and flowers really grow? They absorb what they need from water, air and sunlight! Making sure seeds are hydrated and allowing them time in sun is the way you care for plants, because they're living things, too! Water is the most important thing during germination. Germination is the growth and development of a seed into a plant. Once you have a sprout (the beginning growth of a plant, like a little shoot or stem), sunlight and air become important, too!

What Do Fairy Gardens Need to Grow?

Plants use water, sunlight and carbon dioxide from the air to make their food, and this is called photosynthesis ("photo" means light, and "synthesis" means putting together):

1. The green of the plant's leaves (chlorophyll) absorbs the sun's energy.
2. The energy is used to split water molecules into hydrogen and oxygen.
3. Oxygen is released into the atmosphere (this is what we breathe!).
4. The carbon dioxide from the air, plus the hydrogen, is used to form food to feed the plant!

So, by watering your garden and making sure it gets sunlight, you are feeding your plants and giving them what they need to grow!

Develops important **STEM** skills



SCIENCE • TECHNOLOGY • ENGINEERING • MATH

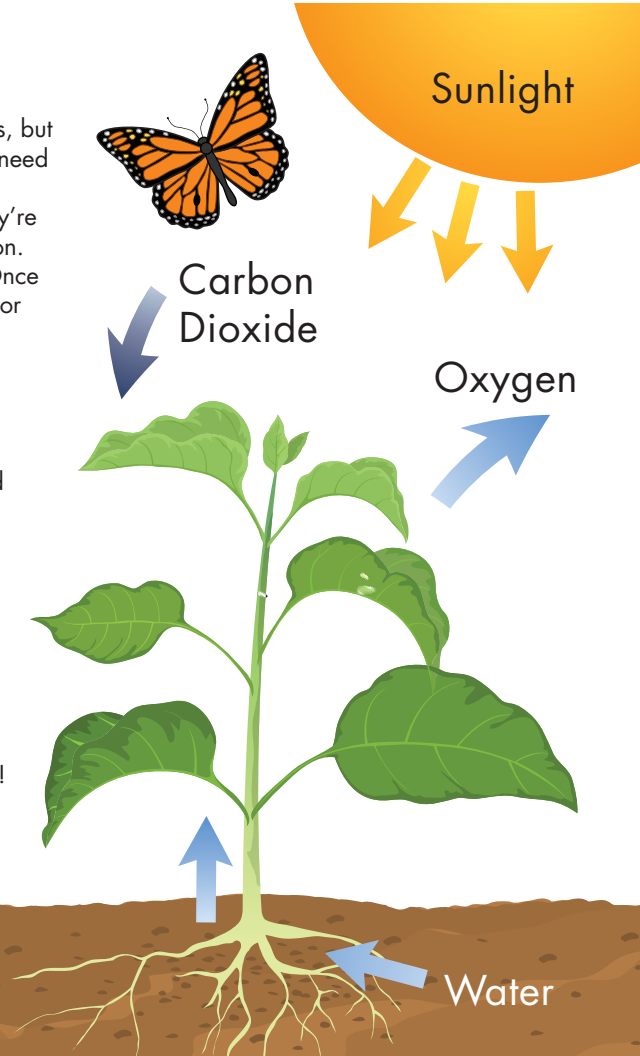

What's in the Seed Packet?

Ryegrass (*Lolium Arundinaceum*)

Mustard (*Brassica Hirta/Sinapis Alba*)

Pea Seeds (*Pisum Sativum*)

Warning: Water may leak from playset. Do not play or set on a surface that could be damaged by water.

Do you have an awesome garden playset? We want to see! Post on Instagram with #PlayMonster, or send us pictures or video:

Customer Service
1400 E. Inman Pkwy.
Beloit WI, 53511
playmonster@playmonster.com
1-800-524-4263

! WARNING:

**CHOKING HAZARD-Small parts.
Not for children under 3 years**

For more fairy fun, visit
playmonster.com

PLAY MONSTER

If you have questions, please contact us.
800-524-4263 - Weekdays 8am to 5pm CST



Copyright © 2019 PlayMonster LLC, 1400 E. Inman Pkwy., Beloit, WI 53511 USA. Made in China. All rights reserved. My Fairy Garden is a trademark of PlayMonster LLC. Parts and colors may vary from those shown.

3641



You can collect other fairies, friends and accessories for even bigger fun!

